

ARDEX WPM 240/247 OR ARDEX WPM 300 FOR DAMP/GREEN CONCRETE

ARDEX WPM 5000HD DPM MEMBRANE

PRECAST CONCRETE WITH NO VOIDS BLOCKWORK WITH FLUSH FINISH TO DPM SIDE

ARDEX DRS 10 GC PROTECTION BOARD

WATER STOP ARDEX WPM 1955

300mm WIDE WPM 3000 UNDER FLASHING TO BRIDGE JOINT

TAPE POLYTHENE DPM TO UNDER FLASHING

100mm SLOTTED DRAIN WITH FILTER FABRIC MINIMUM FALL 1:200 TO DRAINS

DISH DRAIN FORMED WITH SITE CONCRETE WITH 1:200 FALL TO DRAIN

MIN 75mm SITE CONCRETE OR COMPACTED HARDFILL OR SAND BLINDING AS PER ENGINEERS SPECIFICATION

HORIZONTAL DPC NOT COVERED BY ARDEX WARRANTY
ARDEX RECOMMEND TAKING MEMBRANE UNDER ENTIRE SLAB FOR COMPLETE WATERPROOFING

20mm COMPACTED BASE

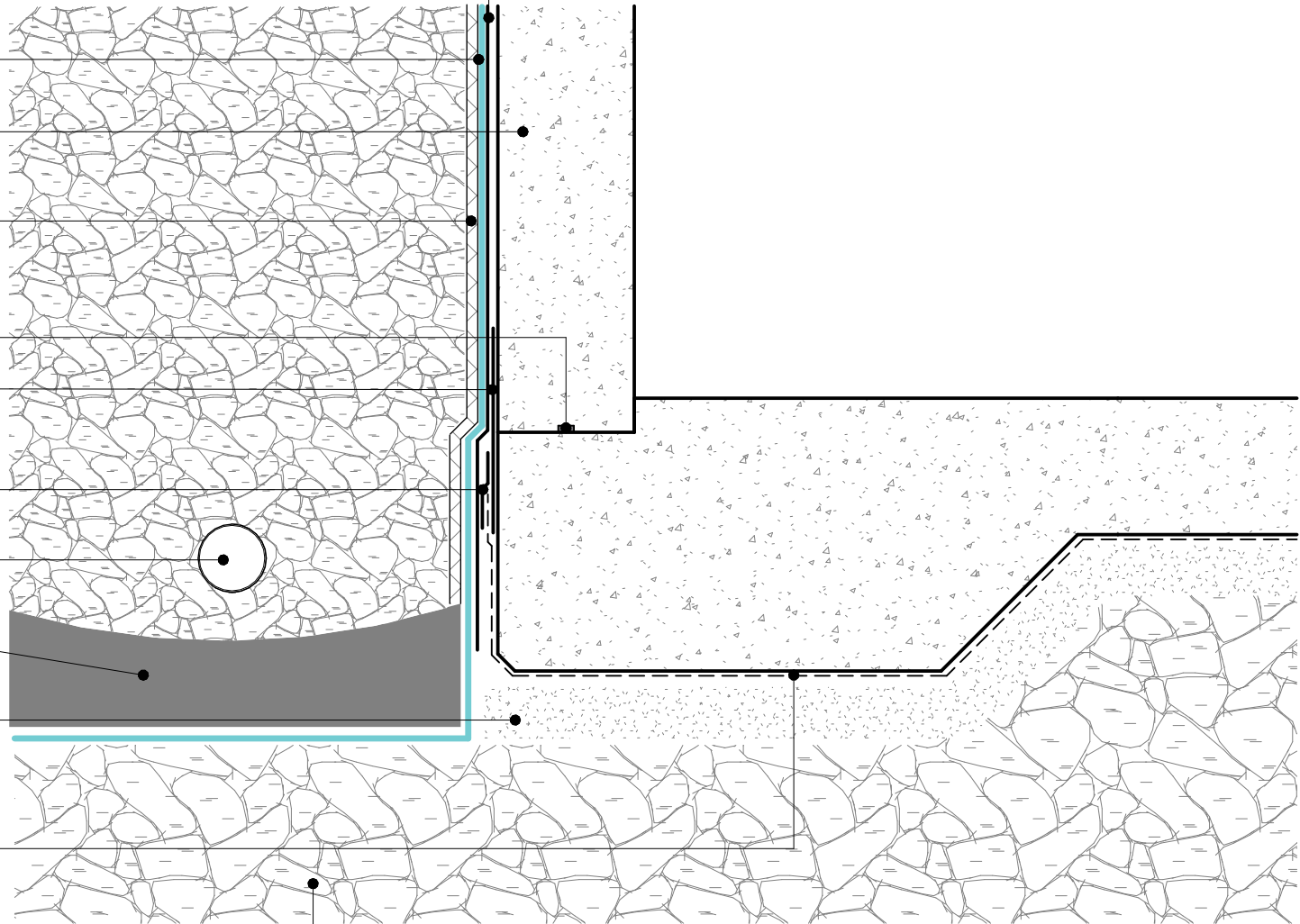

WPM 5000HD

FOOTING JUNCTION NO STEP

DWG NO.

AS-10(HD)

DATE

21.08.2022

SCALE

@ 1/10



Disclaimer: Ardex makes every reasonable effort to ensure that the technical details, recommendations and other information contained in this drawing are accurate and represent our knowledge and experience at the time of design and publication. Ardex reserves the right to change the information without prior notice. Ardex provides the information in good faith with no representations or warranties (whether implied or otherwise), and will not be liable for any losses or damages (whether direct, indirect or consequential) whatsoever, whether in contract, negligence or any other action, arising out of or in connection with the use, or inability to use, the information. It is your responsibility to ensure that our products are used only for the purposes for which they are intended and are used in accordance with any applicable specifications, guidelines, standards, codes of practice, regulations and laws. The supply of our products and services are also subject to certain terms, warranties and exclusions which are available on request.